



CAR AUDIO PLAYER

Car Stereo/Digital Media Player

User manual

Please read this manual before using

Note on installation

- The unit is designed for 12-14V DC, negative ground operation system only .Before installing the unit.
- Make sure your vehicle is connected to DC 12V negative ground electrical system.
- The negative battery terminal must be disconnected before making connections, which can reduce the damaging the unit due to short circuit.
- Be sure to connect the color coded leads correctly according to the diagram .Incorrect connections may cause the unit malfunction or damage the vehicle's electrical system.
- Be sure to connect the speaker (-) leads to the speaker (-) terminal. Never connect the left and right channel speaker cables each other or to the vehicle body.
- Do not block vents or radiator panels. Blocking them will cause heat to build up inside and may result in fire.
- After the completion, of the installation and begin to play the unit (including replacing the battery), please press the reset button on the front panel with pointed objects (such as ball-point pen) to set the unit to initial status.

Specifications Of Common Keys

(Parts of model may not include all contents,please be subject to the actual model.

ICON	DESCRIBE
▶	Play/pause
◀◀ ▶▶	Prev/next(radio Selection And Track Selection)
⬆	Detach The Front Panel
■	Stop
MODE/⏻	Power On/off Control/mode
POWER	Power On/off
LOC	Radio Far And Near Path Selection
MUTE	Mute The Sound
IR	Remote Control Receiver
AUX	This Jack Is For The Out Side Audio Input
EQ	Sound Field/automatic Preset Station
CLK	Clock Function
BAND	Radio Band Selection
MODE	Mode Swith
AMS	Auto Scan And Auto Store
INT	To Play The First 10 Seconds Of Each Track
RDM	Random Play
PRG	Program Play
RESET/RES	Reset The System
RPT	Repeating The Same Track
LOUD	Loudness
DSP	Dispaly Clock
CH+	Track selection(Play/pause function when playing MP3)
CH-	Track selection(RPT/INT/RDM function when playing MP3)
1/2/3/4/5/6	Number Buttons

Installation

Parts List (The numbers in the list are keyed to those in the instructions.)

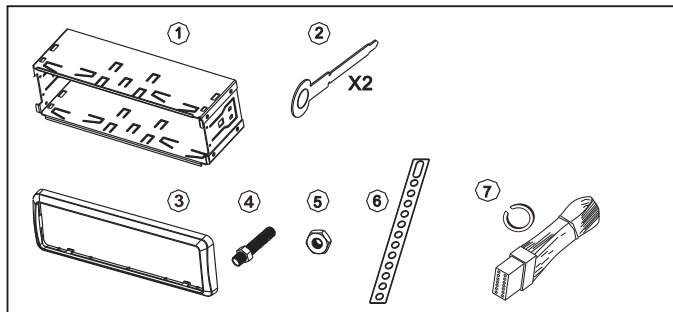

Basic Operation

Power On/Off/Mode

- Preset (POWER) button to turn on the unit,and press power for 3 seconds to turn off the unit
- Press (power/mode)smoothly to turn on the unit ,and the press again to change the function :Radio→Playback→AUX-IN

Aux In Operation

Press MODE button to enter into AUX mode .It in put the AUDIO signal from 3 position .The signal displays on the LCD and there is signal output in the speaker .

U-DISK/SD Card Playback

- Insert U Disk /SD card into USB/SD port ,U disk /SDwill play automatically.Or press MODE button to select if U-dick/SD is loaded.
- Other operations please refer to details of MP3 Playback.

Preset station / AMS

AMS:Automatic Scan /Memory station
Press AMS button to scan /display the memory station by 10 seconds from 1-6 station ,when start AMS function, the frequency flashes continuously until the appropriate station, then play the radio station by press 1-6 number key accordingly.

When press AMS up than 3 seconds, will start the auto memory function, the radio will select the station automatically and store it on the number buttons. Remark: The machine at most store 6 stations per each frequency, pls refer to the number button operation to use the number key.

Band selector

Each time this button is pressed, the radio band is changed. The indication "FM1" "FM2" "FM3" "AM1" "AM2" will appear on the display according to your selection.
Without "AM", is "FM1" "FM2" "FM3".

Tuning/Selecting Tracks

- Long press**
Manual Tuning : press(+||) or (||-)button continuously to select a station upward or downward respectively.
- Short press**
Automatically Tuning: press(+||) or (||-)button the radio automatically searches a station upward or downward respectively and plays when it finds a station.

Basic Operation

MP3 operation

1.Selecting Track /F. F/ REW
Press (◀◀or▶▶) choose your favorite track upward or downward respectively. Press and hold (◀◀or▶▶)button to fast forward or rewind the track upward or downward respectively.

2. Playing Tracks Repeatedly(By remote control)
Press "RPT" button to perform repeat playing function when you need to repeat playing the track you like.
During MP3 version
Press "RPT" button at the first time to repeat playing at the same track. "RPT" appears which indicates repeat playing one track starts. Press "RPT" button again to stop repeat.
During MP3 version. Press "RPT" button at the first time to repeat playing the same track "RPT" appears which indicates repeat playing one track starts.
Press "RPT" button at the second time to stop repeat.

3.Scanning Tracks Automatically (By remote control)
During playback, press"RPT"botton, to play the first 10 seconds of each track on the disc, the display will show "INT" ,ON Which indicates INT function is already activated.
Press "INT" button once more to revert to normal play back,Display will show"INT OFF"

4. Playing Tracks in Random Order (By remote control)
During playback , press "RDM" button,and "RDM"on appears on the display which indicates RDM function is carried out,THE unit plays and trach at random,Press RDM once more to return to normal plyback mode.

5.Stop Playing
During playback, press "stop" on remote button to shop the playback,LCD will show " stop" to return to normal play mode, press play.
note: during Mp3 mode,press STOP on remote button to stop playing.LCD appears STOP.

Specification

General	
Power requirements.....	12-14.4V DC
Load impedance.....	4 Ω
Tone controls.....	±8dB(bass 100Hz,Treble 10KHz)
Audio section	
Maximum output level.....	1Vrms(+/-3dB)
Frequency response.....	.20 to 20KHz
Signal-to-noise radio.....	85dB
Stereo separation.....	80dB
FM Tuner section	
Tuning range.....	87.7-108(Europe/china),87.5-107.9(U.S.A)
IF Range.....	10.7MHz
Usable sensitivity(-30dB).....	15dB
Usable-to-noise radio.....	60dB
Stereo separation.....	30dB(1 KHz)
Frequency response.....	30~15000Hz
AM Tuner section(optional)	
Tuning range.....	522-1620(Europe/china),530-1710(U.S.A)
Usable sensitivity(-20dB).....	48dB
Usable-to-noise radio.....	50dB
Frequency response.....	40~15000Hz

★ Note: Due to continuous product improvement, specifications and design are subject to change without notice.

Trouble shooting

Problem	Cause	Action
Unit will not turn on (no power)	Yellow wire not connected or incorrect voltage	Check connections for proper voltage
	Red wire not connected or incorrect voltage (12-14.4VDC)	Check connections for proper voltage
	Black wire not connected	Check connection to ground
Unit has power (but no sound)	Fuse blown	Replace fuse
	Speaker wires not connected	Check connections at speakers
Unit blows fuses	One or more speaker wires touching each other or touching chassis ground	Insulate all bare speaker wires from each other and chassis ground
	Yellow or red wire touching chassis ground	Check for pinched wire
	Speaker wires touching chassis ground	Check for pinched wire
Excessive skipping	Incorrect fuse rating	Use fuse with correct rating
	Unit is not mounted correctly or back strap is not secure	Check mounting sleeve and back strap support